



Acme Sanitary Ware Co. Ltd.

1/F, Acme Building, 22-28 Nanking Street, Kowloon, Hong Kong
Tel: 2388 7171 Fax: 2710 8012
Email: acme@acmesanitary.com.hk
Website: www.acmesanitary.com.hk



Pure Freude
an Wasser

PROJECT		REF		REV	ITEM CODE	
LOCATION		DATE			PAGE	

SANITARY WARE SPECIFICATION SHEET

Item Descriptions	GROHE (Germany) "Minta" Chrome plated 3/8" single-lever sink mixer with 1 no. of flexible hose	Illustration/ Drawing
Dimensions	L225 x W145 x H353 mm	<p>225 353 186 73 50° 50° Ø54 Ø34 max. 60 445 G^{3/8} 145</p> <p>GROHE SilkMove® GROHE StarLight® EASYDOCK Pull-out Dual Spray SpeedClean PROFESSIONAL-SPRAY</p>
Model	32322002	
Finish / Material	Chrome Plated	
Country of origin Manufacturer	Germany GROHE Limited	
Supplier	Acme Sanitary Ware Co. Ltd Mr. Eric Wong/ Mr. Don Yuen	
Contact Tel/Fax E-mail Website	(852) 2388-7171 / (852) 2710-8012 acme@acmesanitary.com.hk www.acmesanitary.com.hk	
<p>"Minta" Single-lever sink mixer 1/2"</p> <ul style="list-style-type: none"> U spout monobloc installation GROHE StarLight chrome finish GROHE SilkMove 46 mm ceramic cartridge GROHE EasyDock guarantees easy retraction and smooth docking back to the starting position pull-out dual spray diverter: laminar spray/SpeedClean shower jet adjustable flow rate limiter swivel tubular spout swivel area 360° integrated non-return valve protected against backflow flexible connection hoses rapid installation system <div> <p>32322DC2 32322DA2 32322DL2 32322AL2</p> </div>		<p>Colour options:</p> <ul style="list-style-type: none"> 0021 StarLight Chrome DC21 SuperSteel DA21 Warm Sunset A021 Hard Graphite AL21 Brushed Hard Graphite DL21 Brushed Warm Sunset

Note: [Grohe Openbox 32322DC2](https://www.youtube.com/watch?v=Z_9KvYSozKI) https://www.youtube.com/watch?v=Z_9KvYSozKI

* All information of the above is for the reference only. No prior notice is made if any changes.



Acme Sanitary Ware Co. Ltd.

1/F, Acme Building, 22-28 Nanking Street, Kowloon, Hong Kong

Tel: 2388 7171 Fax: 2710 8012

Email: acme@acmesanitary.com.hk

Website: www.acmesanitary.com.hk

Since 1949



Pure Freude
an Wasser

PROJECT		REF		REV	ITEM CODE	
LOCATION		DATE			PAGE	

SANITARY WARE SPECIFICATION SHEET

SPARE PARTS

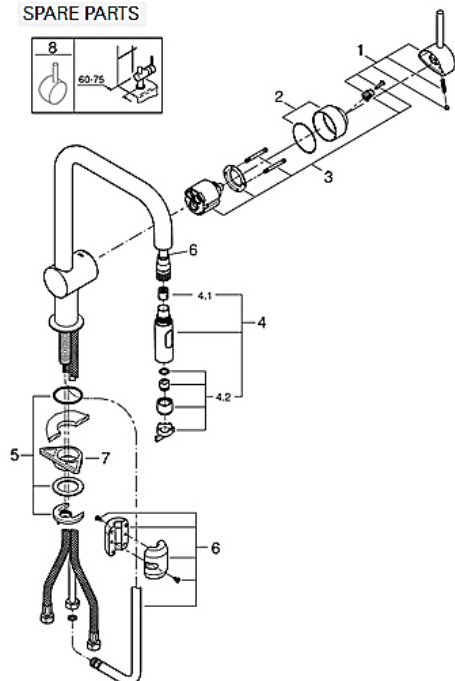

GROHE StarLight®

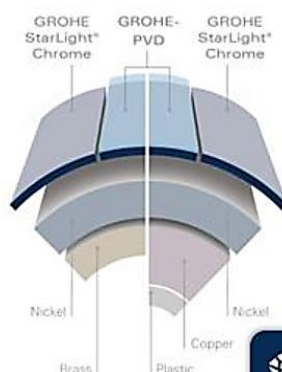

GROHE surface
hardness



GROHE scratch
resistance



PROFESSIONAL-
SPRAY

Swivel range 360°
for effortless convenience



Pos.-nr.	Prod. description	Order-nr.
1	Lever	46015000
2	Cap	46025000
3	Cartridge	46048000
4	Pull out spray	48416000
4.1	Non-return valve	08565000
4.2	Flow straightener	48347000
5	Shank mounting kit	46345000
6	Shower hose	48293000
7	Support plate	05334000
8	Lever	40684000*

* Optional accessories

Pull-out comfort shower head
with spray jet and shower jet



Pull-out Dual Spray



EASYDOCK

GROHE EasyDock
smooth retraction of the shower head

Pull-out comfort shower head
with spray jet and shower jet



Pull-out Dual Spray



Note:

* All information of the above is for the reference only. No prior notice is made if any changes.



水務署
Water Supplies Department

總部 Headquarters

香港灣仔告士打道七號入境事務大樓 48 樓

7 Gloucester Road, Wan Chai, Hong Kong



本署檔號
Our ref.
來函檔號
Your ref.

21/2023 T/J(1199/2023)

電話
Tel.
傳真
Fax.

: 2824 0578

29 December 2023

**Approval of "GROHE" Sink Mixer
(General Acceptance No. C20230971)**

Your E-Application [file-id: ETJ-GA-20231120-172] dated 21 November 2023 and subsequent submission received by this department on 5 December 2023 refer.

Having considered the test reports ref. 222320PC230015B and 202535EN221835B issued on 30 November 2023 and 26 June 2023 by Fugro Technical Services Limited and WRAS certificate, this Authority accepts that the fitting described below complies with, and its use when correctly installed does not contravene, the Waterworks Ordinance and Regulations.

Name of Manufacturer: Grohe AG

Country of Origin: Portugal

Brand: Grohe

Details of Fitting: 3/8" Single lever sink mixer with
1) 1 no. of flexible hose under test report ref. 202535EN221835B &
2) 1 no. of flexible hose approved by UK's WRAS under ref. 2110370



Model: 32322XX2
(where "XX" denotes the code of colour)

Body Markings: 

Expiry Date: 31 October 2026

This Authority hereby permits the use of the above fitting in fresh water plumbing systems subject to full adherence to Waterworks installation requirements. In particular, you are required to draw your customers' attention to the following requirement-

"The cold water supply to the fitting shall be drawn from the same source that supplies the hot water apparatus so as to provide a balanced pressure and to obviate the risk of scalding in the event of a restriction or failure in the water supply."

A condition of this acceptance is that the fitting to be installed shall be replicas of the sample as certified by the testing agent mentioned above and without modifications. This acceptance may be withdrawn at any time if the standard of the fitting installed fails to meet that of the approved sample or if the fitting is found to be unsuitable for use in fresh water plumbing systems.

This acceptance is only applicable to the main body of the fitting, unless otherwise specified.

For the use of the fitting in any project, the General Acceptance Number of this letter must be quoted as a means of identification of acceptance of the fitting by this Authority.

Should you have any enquiries, please contact our Engineer Mr Albert CHOW at tel. no. 3583 4086.

Yours faithfully,



(Terry KUNG)

for Director of Water Supplies

Encl.

c.c. WSD 3321/1/82] - without catalogue
ME/MC] - with soft copy only